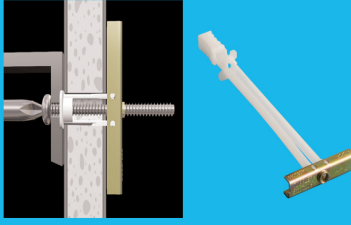
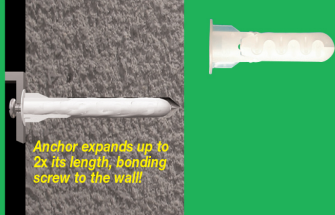
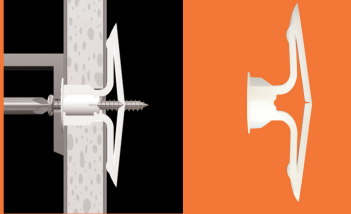
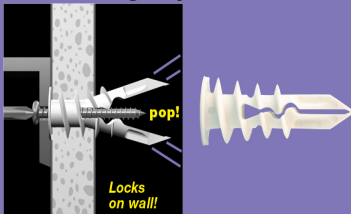
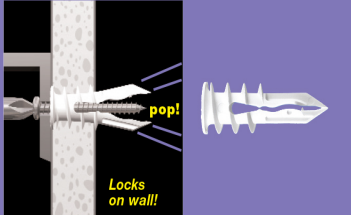
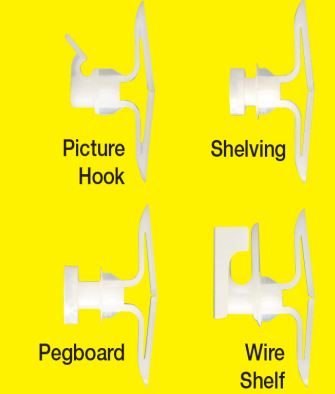

TOGGLER®

High-Performance™ Anchors

Fast, easy & secure anchoring
in **ALL** building materials

	Hollow Materials <i>Drywall, Plaster, Block...</i>	Solid Materials <i>Concrete, Brick, Stone...</i>	
HEAVY Duty Large TV's, Mirrors, Bookshelves, Sinks, Cabinets...	SNAPTOGGLE® Toggle Bolts 	ALLIGATOR® Solid-Wall Anchors  <i>Anchor expands up to 2x its length, bending screw to the wall!</i>	HEAVY Duty Lighting fixtures, Plumbing fixtures, Partitions, Grab bars, Shelving, Cabinets...
MEDIUM Duty Bathroom accessories, Window treatments, Speaker mounts...	TOGGLER® Plastic Toggle Anchors 		to LIGHT Duty Alarms, Thermostats, Smoke detectors...
MEDIUM - LIGHT Duty Small lighting fixtures, Picture frames...	SnapSkrü® Regular Self-Drilling Drywall Anchors  <i>pop!</i> <i>Locks on wall!</i>	In All Walls ... Hollow and Solid ... Drywall to Concrete	
LIGHT Duty Alarms, Thermostats, Smoke detectors...	SnapSkrü® MINI Self-Drilling Drywall Anchors  <i>pop!</i> <i>Locks on wall!</i>	TOGGLER® Anchors for Special Projects  Picture Hook Shelving Pegboard Wire Shelf	

www.togglers.co.nz

Ray Staiger Limited

P. 07 850 4200

F. 07 850 4204

E. rsi@simplefix.co.nz

www.simplefix.co.nz

TOGGLER® Plastic Toggle Anchors

Easy, secure, vibration-proof anchoring for medium loads!

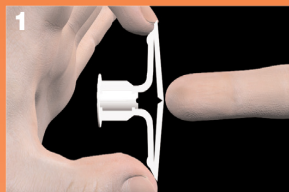

1 Drill 5/16" diameter hole (Ø8mm). Fold anchor in middle.

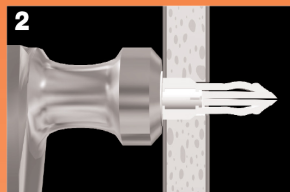

2 Insert anchor in hole and tap flush. Only 3/4" (19mm) clearance needed behind the wall. Only 1/2" (13mm) for the TA anchor.

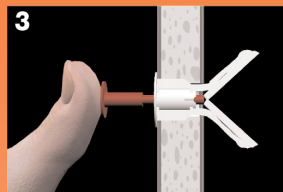

3 Insert key to pop anchor open behind hollow wall (not necessary for thick or solid walls). Do **not** hammer key. Remove key.

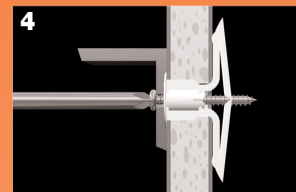

4 Place item over anchor. Insert screw and tighten until flush with item—then stop.

Benefits:

- **Strongest** of all plastic toggle anchors
- **Vibration & shock proof**—won't damage walls or ceiling
Used to install the sprinkler system in the Tokyo subway
- Can use a screw gun—anti-rotation fins **prevent spinning**
- **Greatest grip range** for each anchor:

TA 1/8"-1/4"	TC 5/8"-3/4"	T35 1 ³ / ₈ " [35mm]
TB 3/8"-1/2"	TD 1" [26mm]	T39 1 ¹ / ₂ " [39mm]
- **Greatest screw range** for each anchor:

#6 through #14	TA = #8 through #12
[Ø3.5-6mm dia.]	[Ø4-5.5mm dia.]
- All install in only a small 5/16" hole [Ø8mm]
- Pre-install **without the screw**
- Key-activated **positive** locking system
- Corrosion-proof, nonmagnetic, nonconductive

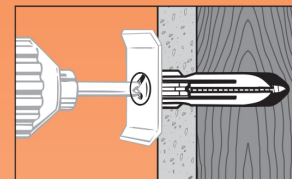

Each anchor holds securely, *even if* it hits an **unexpected solid**, like a stud or the door frame.



TA 1/8"-1/4"
3-6mm

Hollow-core door /
thin panel anchor



TB 3/8"-1/2"
9-13mm

Residential
drywall anchor



TC 5/8"-3/4"
16-19mm

Commercial
drywall anchor

Ultimate Load in Pounds

Anchor:	TA®	TB®	TC®
Tensile			
Plywood	1/4" 124	1/2" 175	-
3/8" Drywall	-	97	-
1/2" Drywall	-	143	-
5/8" Drywall	-	102*	159
Shear			
Plywood	1/4" 265	-	-
3/8" Drywall	-	126	-
1/2" Drywall	126*	167	-
5/8" Drywall	-	214*	237
Grip range:	1/8"-1/4"	3/8"-1/2"	5/8"-3/4"
Drill diameter:	5/16"	5/16"	5/16"
Screw tested:	#8 x 1 1/4"	#8 x 1 1/2"	#8 x 1 3/4"

* Used as wedge anchors [not toggled fully open] in walls thicker than the anchor's grip range

For Medium Holding in:

- Drywall
- Gypsum board
- Plasterboard
- Greenboard
- Fiberglass
- Hollow-core doors
- Thin paneling
- Sheet metal
- Acoustic ceilings
- Masonite® panels

Ideal for Mounting:

- Towel bars
- Window treatments
- Bath accessories
- Kitchen accessories
- Smoke detectors
- CO detectors
- Electric boxes
- Lighting fixtures
- Mirrors on hollow-core doors
- Signs
- Alarms
- Clocks
- Shelving
- Telephones
- Thermostats
- Marine hardware
- Speaker mounts

www.togglers.co.nz