

Producer Statement



February 2019 V2

Pryda Frame Fix (Electrical Option)

This Producer Statement is issued by Pryda New Zealand to inform the users of the use and installation method of the **Pryda Frame Fix** for both structural applications and durability as required by the New Zealand Building Code Clauses B1 & B2 respectively

PRODUCT CODED AND DESCRIPTION

The Pryda code for the Pryda Frame Fix is **PFF**. The **PFF** is manufactured from Z275 1.6mm thick galvanised steel. Each **PFF** is 240mm long x 86mm wide 'U' channel with 35mm folded up-stands along the longer length, with a further 10mm inward fold on the upstands. The **PFF** is pre-punched with 1 x 35 x 140mm hole and 9 x 6.3mm screw holes.

PRODUCT APPLICATION

The **PFF** is intended to reinstate the structural integrity of both 90 x 45mm and 135 x 45mm wall frame studs and top plates (including a top plate packer if used) that have a service hole of no greater than 35 x 140mm drilled through it's centre.

INSTALLATION

Installation is self evident and normal good building practice is assumed during installation. The 35 x 140mm service hole can be made in any position along the top plate provided that the hole edge is no closer than 45mm from a stud.

The 35 x 140mm hole shall be centred across the top plate or stud to accommodate the pre-punched **PFF**. The **PFF** shall be fitted to the inside of the frame leaving clean faces to both the outside edges of the timber. When being used as a top plate stiffener with a top plate packer then Type17 14g x 75mm hex head screws should be used. With a single top plate application then the Type17 12g x 35mm hex head screws should be used.

HANDLING

Prior to use the **PFF** shall be stored in a weatherproof environment and be protected from moisture. Care must be taken to avoid any damage to the surface of the product that may affect the protective galvanised coating.

STRUCTURAL INTEGRITY AND STRENGTH

The installed **PFF** will reinstate the top plate or stud to the integrity of the timber prior to the hole being drilled. This is calculated using the verification methods in accordance with the NZBC standards including NZS3603:1993

DURABILITY

The durability of the **PFF** is in accordance with the acceptable solutions contained in Table 4.1 of NZS3604:2011 and is intended for use in internal "closed spaces". It is not suitable where this table specifies 304 stainless steel.

A C van Blerk. Bsc(Eng), MPIENZ (214689), CPEng IntPE
Engineering Manager-Pryda New Zealand



A Division of ITW New Zealand Ltd

:: Pryda New Zealand

Head Office: 8 Orbit Drive, Albany, Auckland
PO Box 305290, Triton Plaza, North Shore 0757, Auckland

Free Phone: 0800 88 22 44
Website: www.pryda.co.nz

Offices in Napier, Wellington and Christchurch.

For contact details in your area visit www.pryda.co.nz or email office@pryda.co.nz

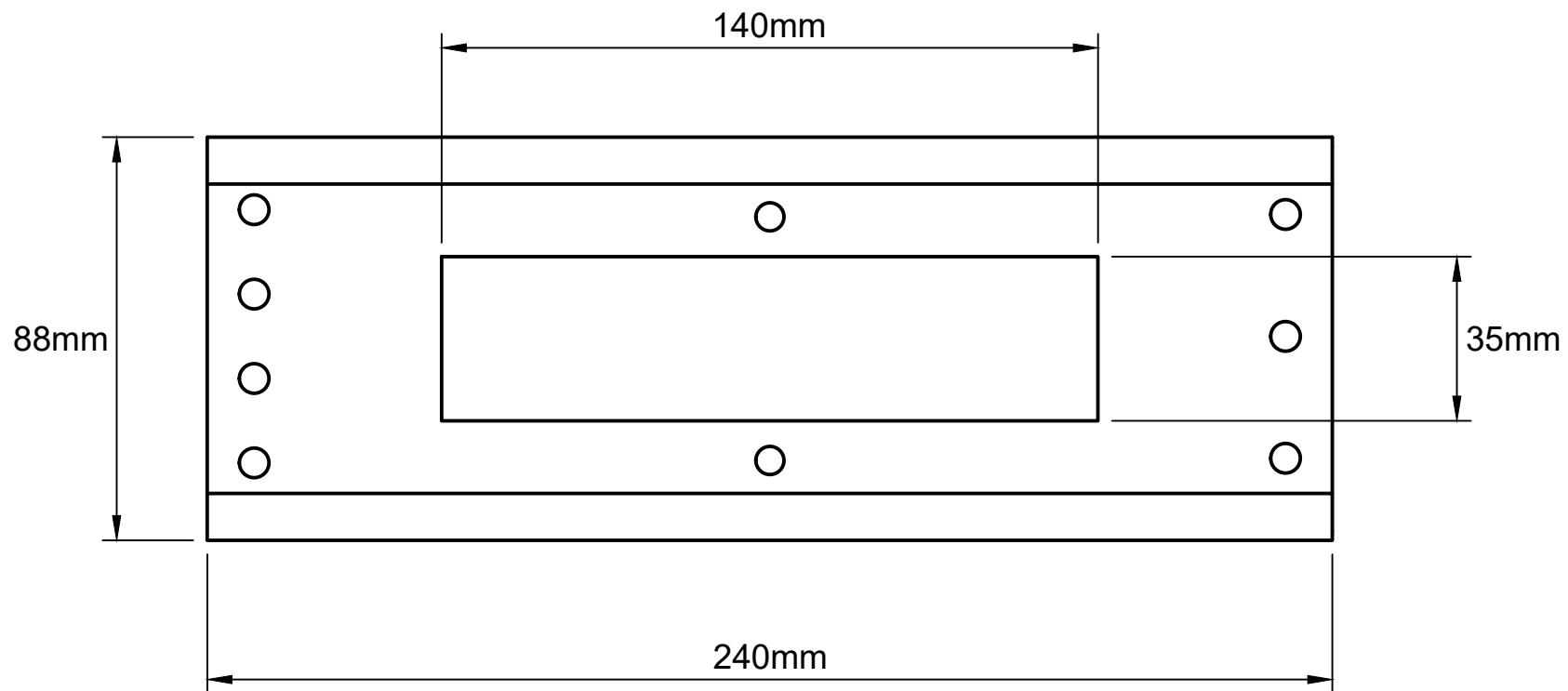

Date
19/05/2021